

90201178

THIRD BRAKE LIGHT ANTENNA MOUNT 2019 + RAM 1500

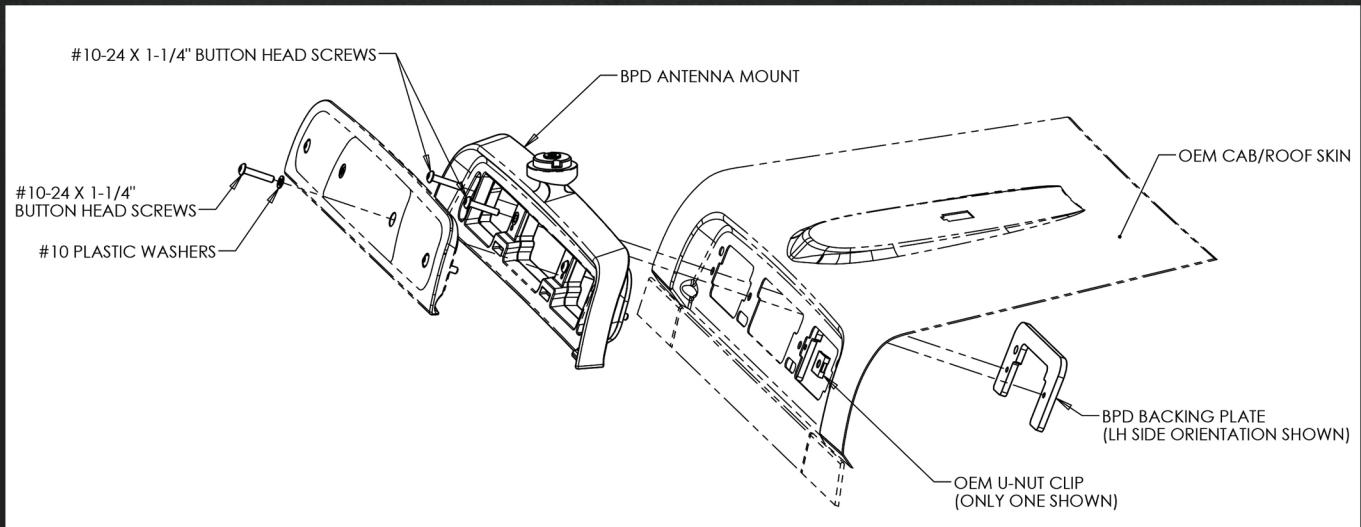

1. REMOVE THE FACTORY THIRD BRAKE LIGHT BY FIRST REMOVING THE FOUR (4) PHILLIPS SCREWS. DISCONNECT FACTORY HARNESS PLUG BEFORE SETTING THE LIGHT ASIDE FOR LATER INSTALLATION.
2. REMOVE THE FOUR (4) FACTORY U-NUT CLIPS AND PLACE SOMEWHERE SAFE (IN CASE YOU WISH TO RETURN TO STOCK) ALONG WITH THE (4) FOUR FACTORY PHILLIPS SCREWS.
3. ENSURE THE PAINTED CAB SURFACE IS CLEAN AND FREE OF DEBRIS BEFORE CONTINUING WITH INSTALLATION.
4. SLIDE BACKING PLATES IN ORIENTATION SHOWN IN DIAGRAM ABOVE THROUGH CENTER LIGHT OPENING.
5. ROUTE THE ANTENNA CABLE THROUGH THE CENTER LIGHT OPENING INTO THE CAB OF THE TRUCK BEFORE GENTLY ALIGNING THE BPD ANTENNA MOUNT TO THE CAB LIGHT POCKET. ENSURE CABLE IS CLEAR OF ANY SHARP EDGES.
6. APPLY MEDIUM STRENGTH THREAD LOCKER AND THREAD EACH OF THE SUPPLIED FOUR (4) #10-24 X 1 1/4" BUTTON HEAD SCREWS INTO THE BACKING PLATES. AFTER DOUBLE CHECKING ALIGNMENT BETWEEN THE ANTENNA MOUNT AND CAB, TORQUE ALL FOUR (4) OF THE FASTENERS TO 20-22 IN-LB.
7. RECONNECT THE FACTORY LIGHT HARNESS AND PLACE OEM LIGHT INTO BPD ANTENNA MOUNT. ENSURE ANTENNA CABLE IS CLEAR OF OBSTRUCTION BEFORE PROCEEDING WITH INSTALLATION.
8. PLACE REMAINING SUPPLIED FOUR (4) #10-24 X 1 1/4" BUTTON HEAD SCREWS THROUGH THE FOUR PLASTIC WASHERS AND INSTALL INTO CAB LIGHT PER FACTORY TORQUE SPECIFICATIONS.
9. CHECK AND CONFIRM LIGHT FUNCTIONS PRIOR TO DRIVING ON ANY PUBLIC ROADS.

@BULLETPROOFDESL



480.247.2331 • 888.967.6653 • bulletproofdiesel.com

